

POWERBLOCK HOME RACK STAND WITHOUT TRAY ASSEMBLY INSTRUCTIONS

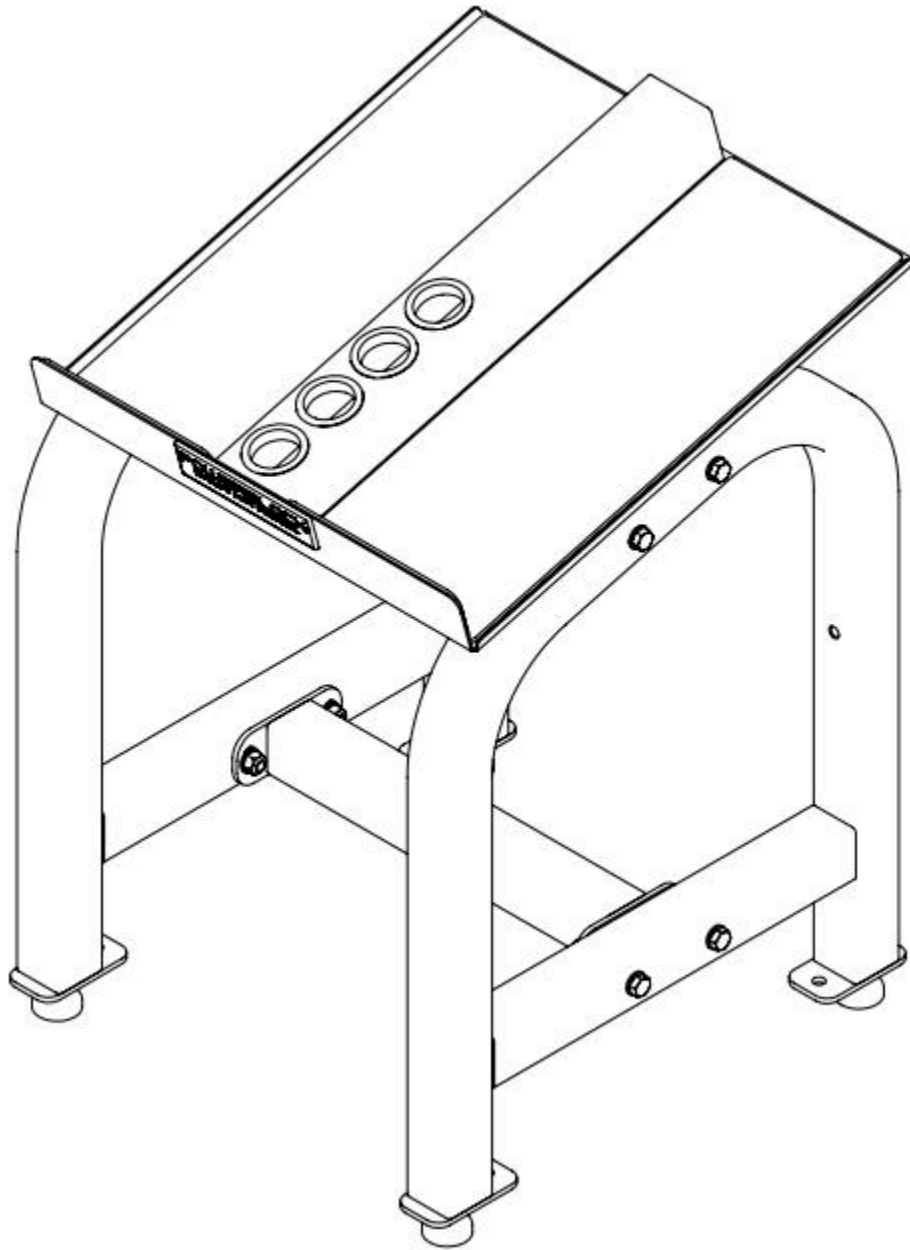

POWERBLOCK HOME RACK STAND WITHOUT TRAY ASSEMBLY

PAGE 1

ITEM NO.	DESCRIPTION	QTY.
1	HOME RACK STAND LEGS	2
2	HOME RACK STAND TOP TRAY	1
3	HOME RACK STAND BOTTOM SPACER	1
4	M10 - 1.5 mm X 70 mm HEX HEAD BOLTS	8
5	M10 WASHERS	16
6	M10 - 1.5 mm LOCK NUTS	8

TOOLS NEEDED: TWO 17mm WRENCHES.

1. ATTACH STAND BOTTOM TRAY (ITEM 3) TO ONE STAND LEG (ITEM 1) WITH SUPPLIED HARDWARE. DO NOT TIGHTEN HARDWARE.
2. ATTACH OTHER STAND LEG (ITEM 1) TO STAND BOTTOM TRAY (ITEM 3) WITH SUPPLIED HARDWARE. DO NOT TIGHTEN HARDWARE.

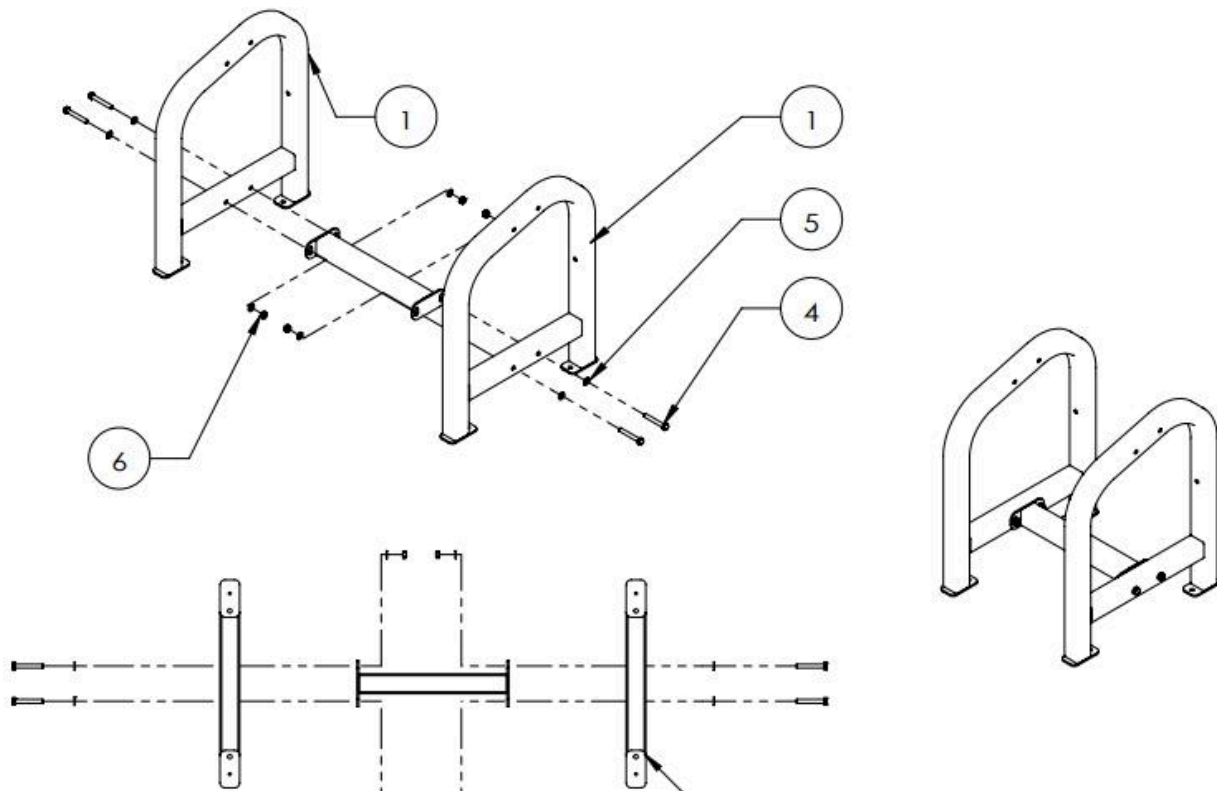

POWERBLOCK HOME RACK STAND WITHOUT TRAY ASSEMBLY

PAGE 2

3. ATTACH STAND TOP (ITEM 2) TO ONE STAND LEG (ITEM 1) WITH SUPPLIED HARDWARE. DO NOT TIGHTEN HARDWARE.
4. ATTACH OTHER STAND LEG (ITEM 1) TO STAND TOP (ITEM 2) WITH SUPPLIED HARDWARE. DO NOT TIGHTEN HARDWARE.
5. TIGHTENING THE HARDWARE WHILE ENSURING ALL FOUR FEET ARE IN FULL CONTACT WITH THE GROUND. INSTALL THE INCLUDED LEVELING MOUNTS IF NECESSARY(SEE NEXT PAGE)

FOR USE ON FIRM AND FLAT SURFACE ONLY

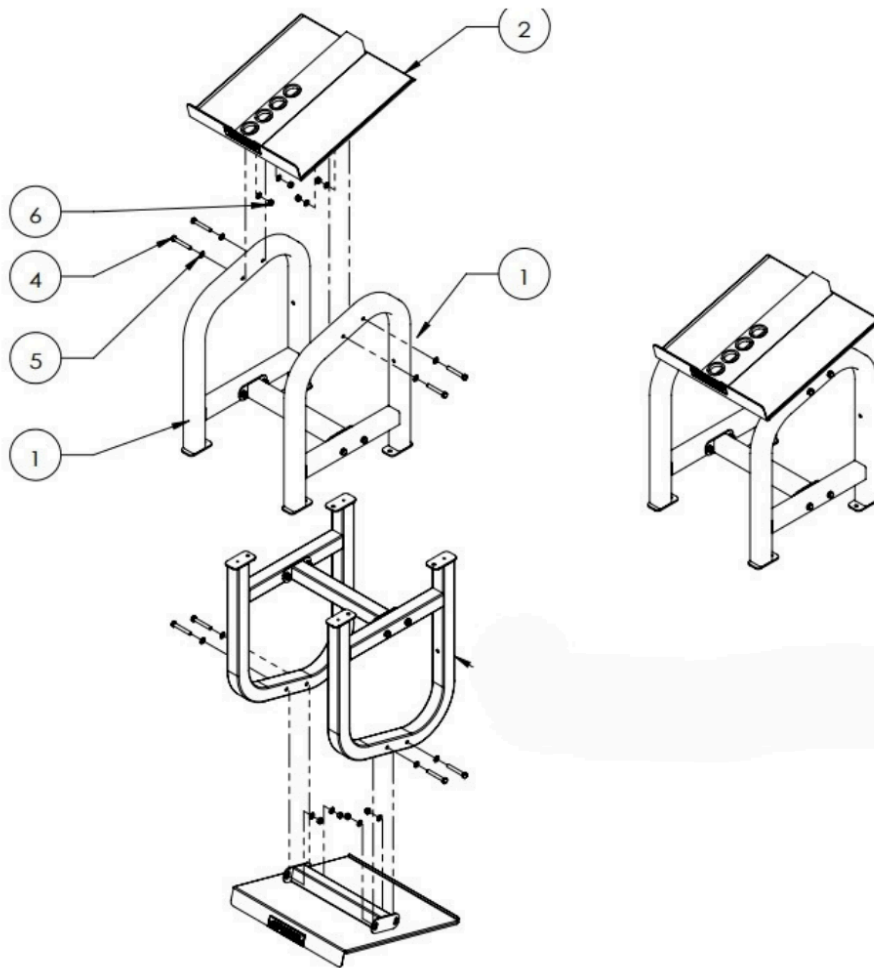

POWERBLOCK HOME RACK STAND WITHOUT TRAY ASSEMBLY

PAGE 3

ITEM NO.	DESCRIPTION	QTY.
1	LEVELING MOUNTS	4

1. **OPTIONAL:** ATTACH LEVELING MOUNTS (ITEM 1) TO BOTTOM FOOT PLATES AND ADJUST THE HEIGHT OF THE LEVELING MOUNTS BY LOOSENING OF TIGHTENING OF THE THREADS. THEN TIGHTENING THE JAM NUTS.

FOR USE ON FIRM AND FLAT SURFACE ONLY

