

POWERBLOCK HOME RACK STAND ASSEMBLY INSTRUCTIONS

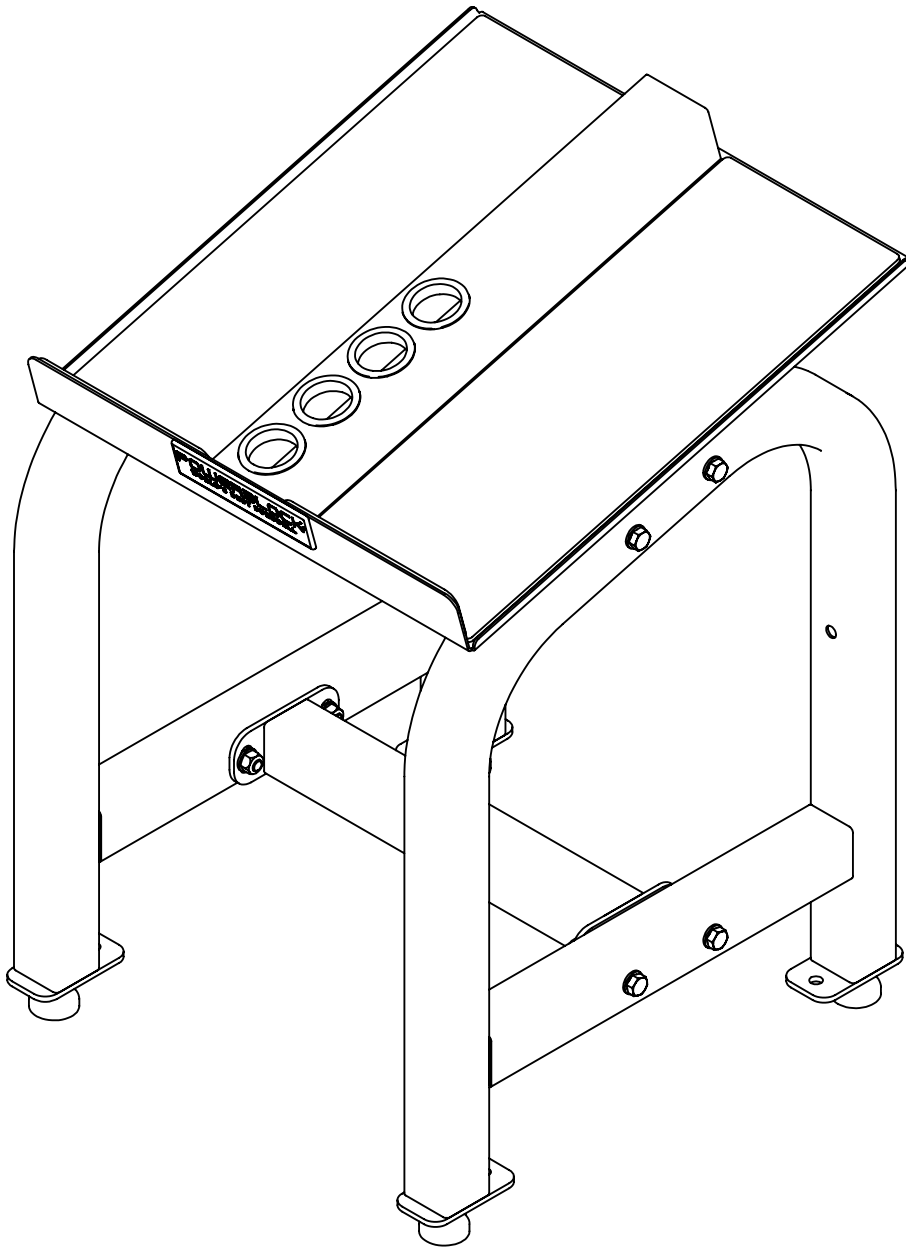

POWERBLOCK HOME RACK STAND

ASSEMBLY PAGE 1 OF 3

| ITEM NO. | DESCRIPTION | QTY. |
|----------|-------------------------------------|------|
| 1 | HOME RACK STAND LEGS | 2 |
| 2 | HOME RACK STAND TOP TRAY | 1 |
| 3 | HOME RACK STAND BOTTOM SPACER | 1 |
| 4 | M10 - 1.5 mm X 70 mm HEX HEAD BOLTS | 8 |
| 5 | M10 WASHERS | 16 |
| 6 | M10 - 1.5 mm LOCK NUTS | 8 |

TOOLS NEEDED: TWO 17mm WRENCHES.

1. ATTACH THE BOTTOM SPACER (ITEM 3) TO ONE STAND LEG (ITEM 1) WITH SUPPLIED HARDWARE. DO NOT TIGHTEN HARDWARE.
2. ATTACH OTHER STAND LEG (ITEM 1) TO THE BOTTOM SPACER (ITEM 3) WITH SUPPLIED HARDWARE. DO NOT TIGHTEN HARDWARE.

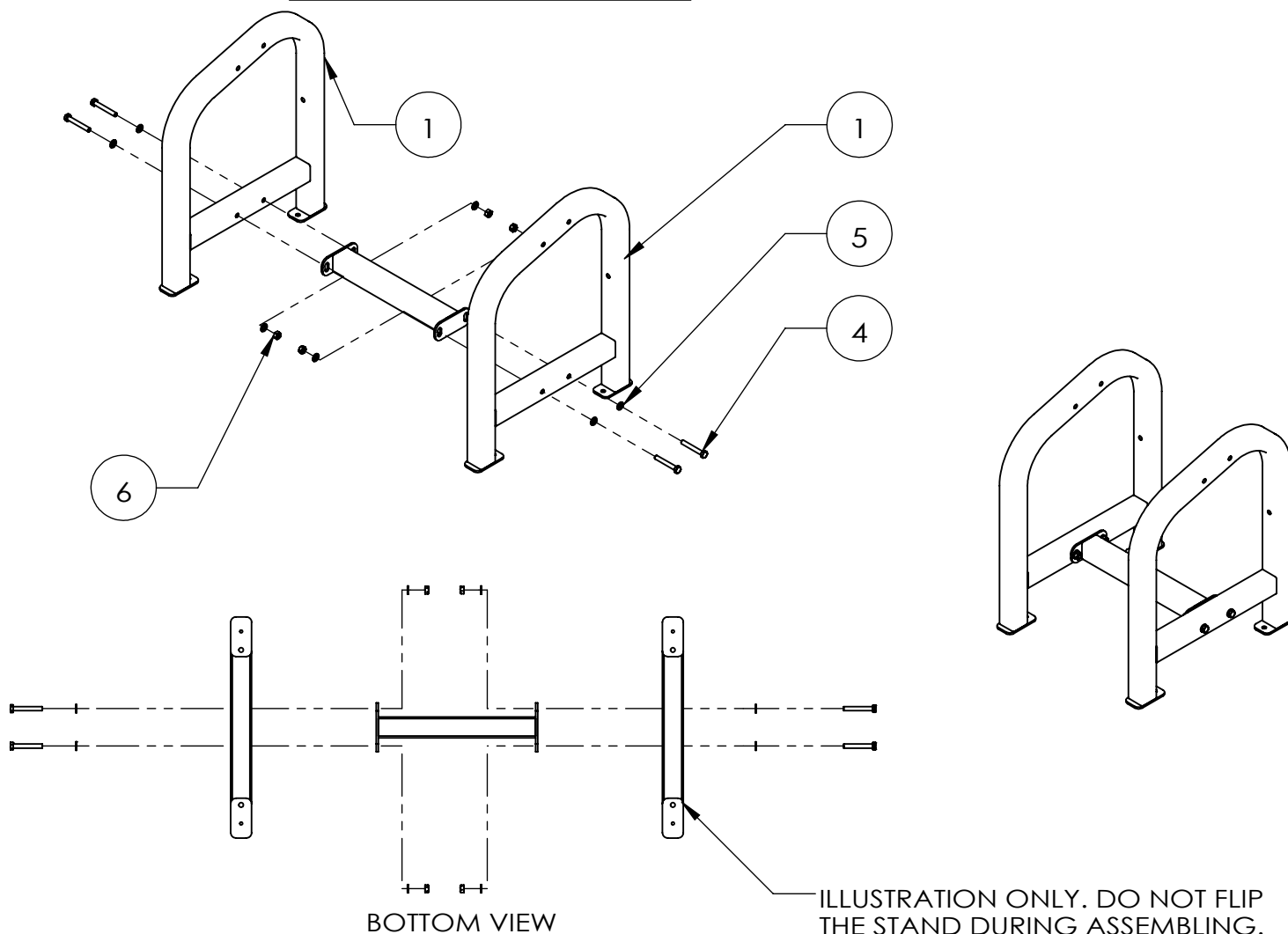

POWERBLOCK HOME RACK STAND ASSEMBLY PAGE 2 OF 3

3. ATTACH STAND TOP (ITEM 2) TO ONE STAND LEG (ITEM 1) WITH SUPPLIED HARDWARE.
DO NOT TIGHTEN HARDWARE.
4. ATTACH OTHER STAND LEG (ITEM 1) TO STAND TOP (ITEM 2) WITH SUPPLIED HARDWARE.
DO NOT TIGHTEN HARDWARE.
5. TIGHTENING THE HARDWARE WHILE ENSURING ALL FOUR FEET ARE IN FULL CONTACT WITH THE GROUND. INSTALL THE INCLUDED LEVELING MOUNTS IF NECESSARY(SEE NEXT PAGE).

FOR USE ON FIRM AND FLAT SURFACE ONLY

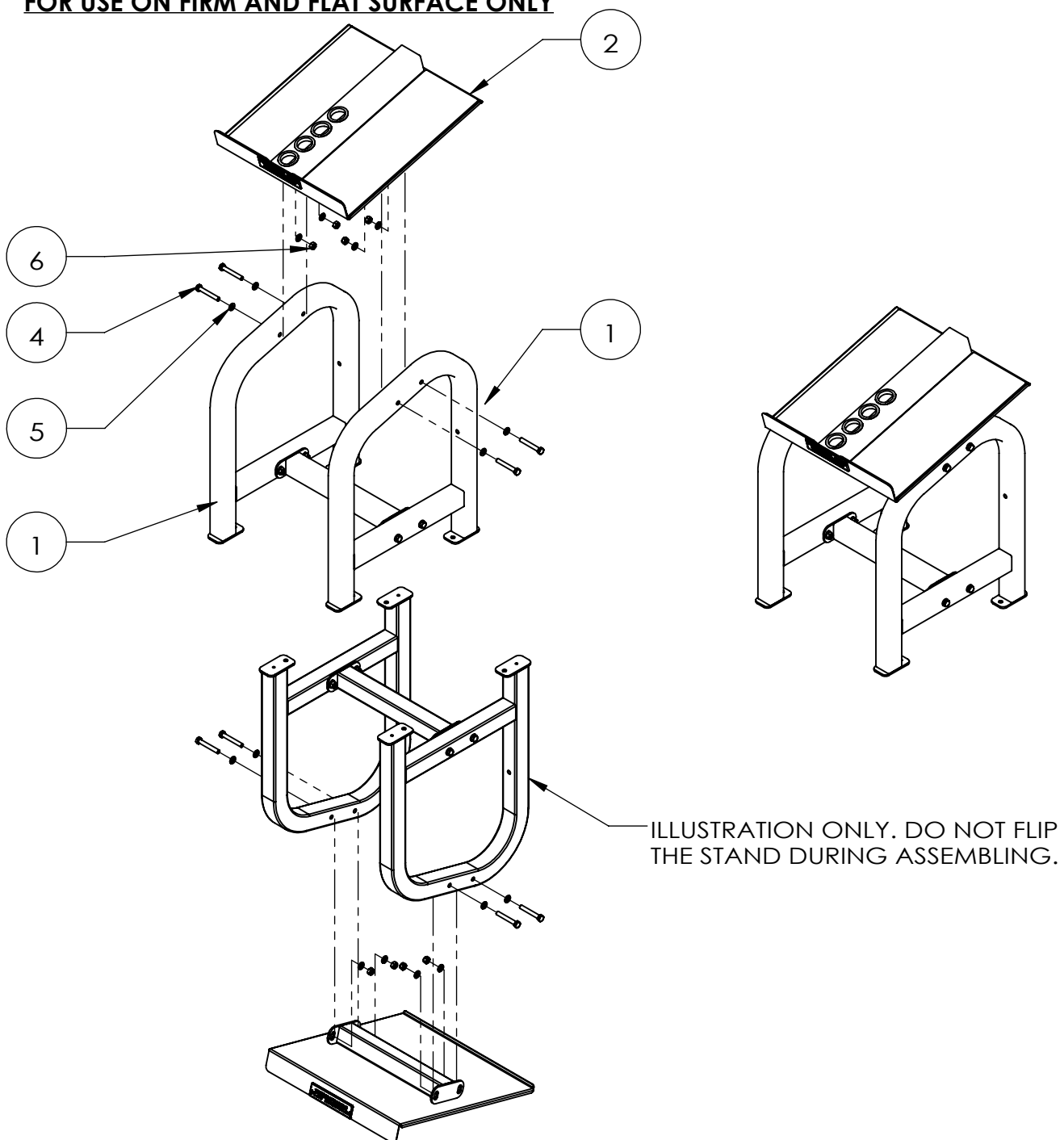

POWERBLOCK HOME RACK STAND

ASSEMBLY PAGE 3 OF 3

| ITEM NO. | DESCRIPTION | QTY. |
|----------|-----------------|------|
| 1 | LEVELING MOUNTS | 4 |

1. **OPTIONAL:** ATTACH LEVELING MOUNTS (ITEM 1) TO BOTTOM FOOT PLATES AND ADJUST THE HEIGHT OF THE LEVELING MOUNTS BY LOOSENING OR TIGHTENING OF THE THREADS. THEN TIGHTEN THE JAM NUTS.

FOR USE ON FIRM AND FLAT SURFACE ONLY

